

## PS-12280 12 Volt 28.0 AH

### Rechargeable Sealed Lead Acid Battery



#### Terminals

(mm)

- NB1: Tin plated brass post with 'Nut & Bolt' fasteners

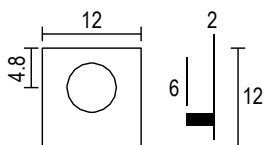

#### Physical Dimensions: in (mm)

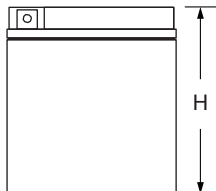
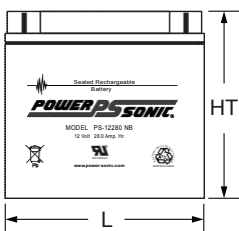
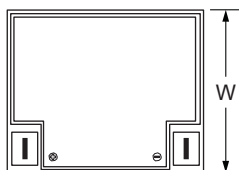

L: 6.50 (165) W: 4.92 (125) H: 6.97 (177) HT: 6.97 (177)

Tolerances are +/- 0.04 in. (+/- 1mm) and +/- 0.08 in. (+/- 2mm) for height dimensions. All data subject to change without notice.

#### Features

- Absorbent Glass Mat (AGM) technology for superior performance
- Valve regulated, spill proof construction allows safe operation in any position
- Power/volume ratio yielding unrivaled energy density
- Rugged impact resistant ABS case and cover (UL94-HB)
- Approved for transport by air. D.O.T., I.A.T.A., F.A.A. and C.A.B. certified
- U.L. recognized under file number MH 20845

#### Performance Specifications

**Nominal Voltage** ..... 12 volts (6 cells)

#### Nominal Capacity

20-hr.	(1.4A to 10.50 volts)	28.0 AH
10-hr.	(2.62A to 10.50 volts)	26.2 AH
5-hr.	(5A to 10.20 volts)	25.0 AH
1-hr.	(18.6A to 9.00 volts)	18.6 AH
15-min.	(58.8A to 9.00 volts)	14.7 AH

**Approximate Weight** ..... 20.70 lbs. (9.39 kg)

**Energy Density** (20-hr. rate) ..... 1.51 W-h/in<sup>3</sup> (91.99 W-h/l)

**Specific Energy** (20-hr. rate) ..... 16.23 W-h/lb (35.79 W-h/kg)

**Internal Resistance** (approx.) ..... 10 milliohms

**Max Discharge Current** (7 Min.) ..... 84.0 amperes

**Max Short-Duration Discharge Current** (10 Sec.) ..... 280.0 amperes

**Shelf Life** (% of nominal capacity at 68 °F (20 °C))

1 Month	97%
3 Months	91%
6 Months	83%

#### Operating Temperature Range

Charge..	-4 °F (-20 °C) to 122 °F (50 °C)
Discharge	-40 °F (-40 °C) to 140 °F (60 °C)

**Case** ..... ABS Plastic

**Power-Sonic Chargers** ..... PSC-124000A, 124000A-C

### Shelf Life & Storage

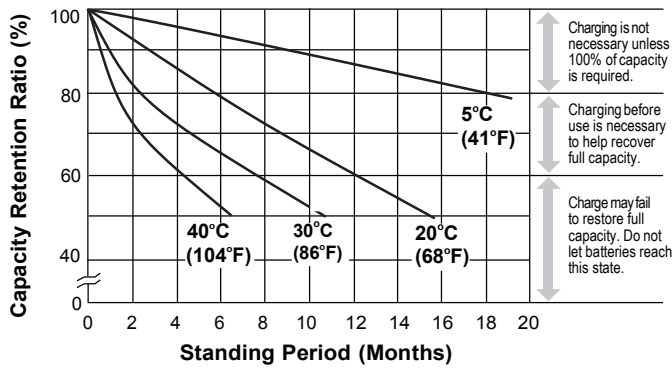

### Discharge Time vs. Discharge Current

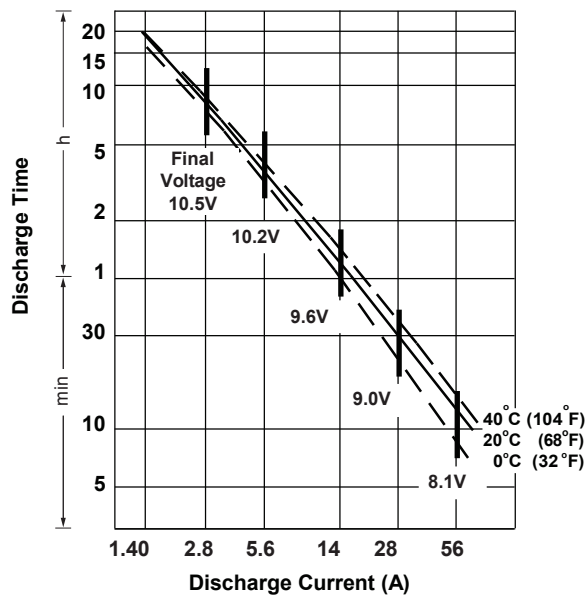

### Charging

**Cycle Applications:** Limit initial current to 8.4A. Charge until battery voltage (under charge) reaches 14.4 to 14.7 volts at 68°F (20°C). Hold at 14.4 to 14.7 volts until current drops to under 280mA. Battery is fully charged under these conditions, and charger should be disconnected or switched to “float” voltage.

**“Float” or “Stand-By” Service:** Hold battery across constant voltage source of 13.5 to 13.8 volts continuously. When held at this voltage, the battery will seek its own current level and maintain itself in a fully charged condition.

**Note:** Due to the self-discharge characteristics of this type of battery, it is imperative that they be charged within 6 months of storage, otherwise permanent loss of capacity might occur as a result of sulfation.

### Chargers

Power-Sonic offers a wide range of chargers suitable for batteries up to 100AH. Please refer to the Charger Selection Guide in our specification sheets for “C-Series Switch Mode Chargers” and “Transformer Type A and F Series”. Please contact our Technical department for advice if you have difficulty in locating suitable models.

### Discharge Characteristics

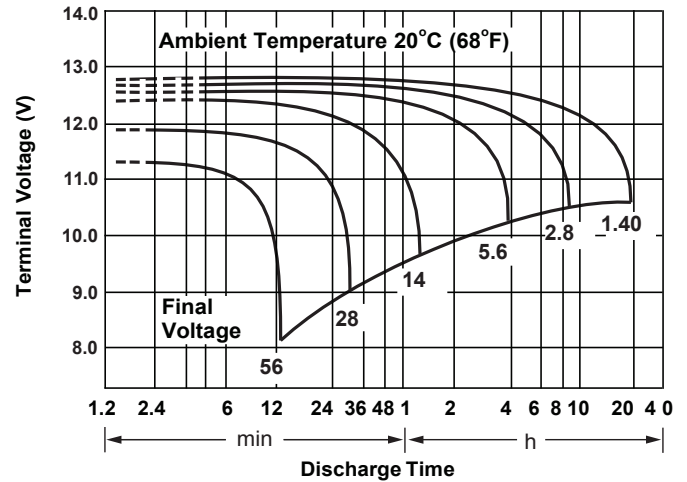

### Life Characteristics in Stand-By Use

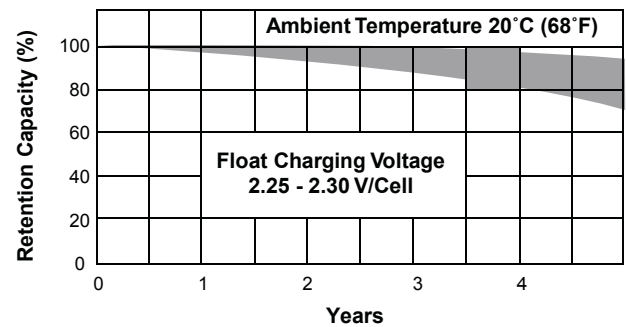

### Life Characteristics in Cyclic Use

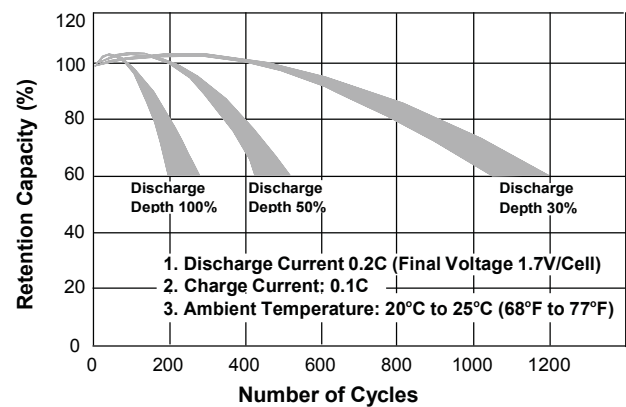

### Further Information

Please refer to our website [www.power-sonic.com](http://www.power-sonic.com) for a complete range of useful downloads, such as product catalogs, material safety data sheets (MSDS), ISO certification, etc..